

# DI BLIND FLANGES

MODEL LVFLBFD



**FEATURES:**

- Material: Ductile Iron, ASTM-A536, Grade 70-50-05 or 60-42-10
- Pressure rating: 250 PSI
- In accordance with ANSI/AWWA C110/A21.10-03
- Available with tapped center hole 2"-11½ TPI/ANSI B2.1
- UL/FM Listed and Approved
- Complies with NSF61
- Primed orange on one side
- Full face gasket must be used

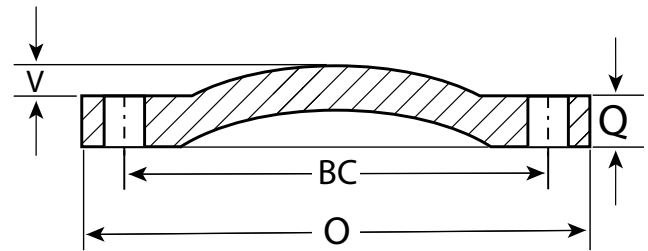
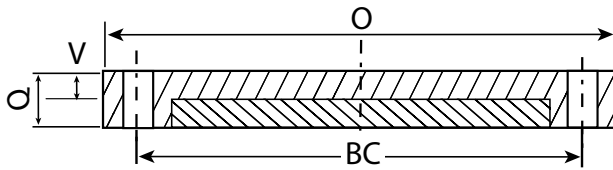

\*Not to Scale

3"-10" BLIND FLANGE							
Size (In.)	O	Q	V	Bolt Circle	Hole Size	No. of Holes	WT
3	7.50	0.75	0.69	6.0	0.75	4	10
4	9.00	0.94	0.88	7.5	0.75	8	18
6	11.0	1.00	0.94	9.5	0.88	8	27
8	13.50	1.12	1.06	11.75	0.88	8	45
10	16.00	1.19	1.12	14.25	1.00	12	65

12"-24" BLIND FLANGE							
Size (In.)	O	Q	V	Bolt Circle	Hole Size	No. of Holes	WT
12	19.00	1.25	0.81	17.0	1.00	12	86
14	21.00	1.38	0.88	18.75	1.13	12	123
16	23.50	1.44	1.00	21.25	1.13	16	146
18	25.00	1.56	1.06	22.75	1.25	16	167
20	27.50	1.69	1.12	25.0	1.25	20	249
24	32.00	1.88	1.25	29.50	1.38	20	321

PROJECT	APPROVAL STAMP
PROJECT:	<input type="checkbox"/> APPROVED
ADDRESS:	<input type="checkbox"/> APPROVED AS NOTED
ENGINEER:	<input type="checkbox"/> NOT APPROVED
SUBMITTAL DATA:	REMARKS:
NOTES 1:	
NOTES 2:	