

LANSDALE

VALVE & MANUFACTURING

1040 Broadway Westville, NJ 08093 / Phone: (800)908-0523 / Fax: (856)456-9223 / www.gemfiresprinkler.com

BRASS

EXTENSIONS

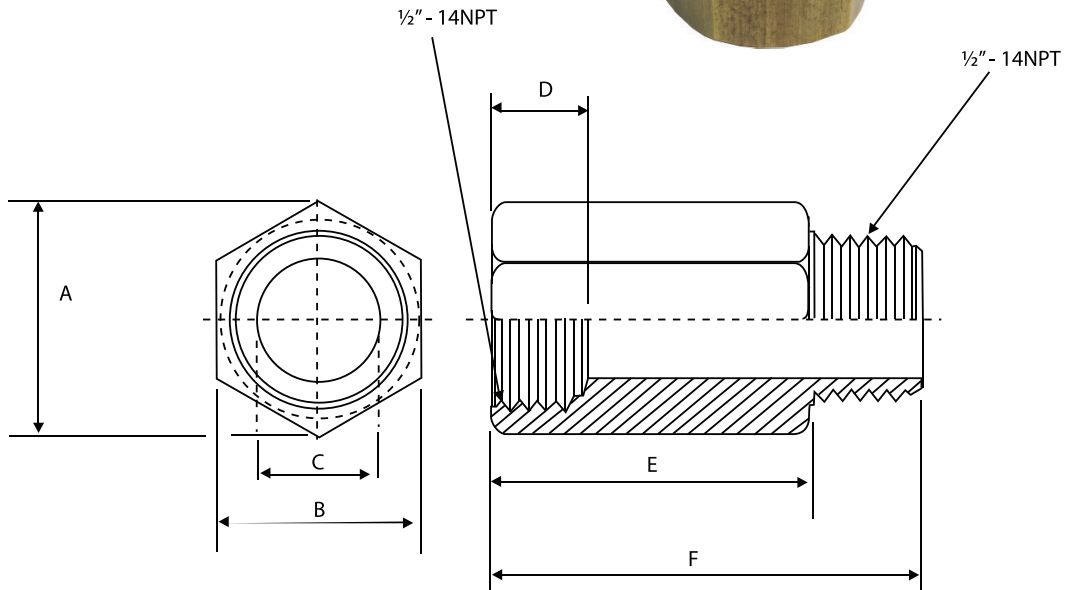

Size	A	B	C	D	E	F
1/2" x 1/2"	1.079"	9.49"	.567"	.516"	.535"	1.031"
1/2" x 3/4"	1.079"	9.49"	.567"	.531"	.787"	2.016"
1/2" x 1"	1.079"	9.49"	.567"	.547"	.965"	1.5"
1/2" x 1 1/2"	1.079"	9.49"	.567"	.547"	1.488"	2.016"
1/2" x 2"	1.079"	9.49"	.567"	.535"	2.008"	2.532"
3/4" x 1/2"	1.346"	1.181"	.709"	.524"	.539"	1.035"
3/4" x 3/4"	1.346"	1.181"	.709"	.62"	.68"	1.27"
3/4" x 1"	1.346"	1.181"	.709"	.62"	.91"	1.5"

Caution: Do not exceed 15 foot pounds torque. Over tightening will cause the sprinkler extension to crack and leak. See additional warnings regarding waiver of liability and use.

PROJECT		APPROVAL STAMP
PROJECT:		<input type="checkbox"/> APPROVED
ADDRESS:		<input type="checkbox"/> APPROVED AS NOTED
ENGINEER:		<input type="checkbox"/> NOT APPROVED
SUBMITTAL DATA:		REMARKS:
NOTES 1:		
NOTES 2:		

Revision: 1/2019