

# BRASS EXTENSIONS

## MODEL LVBEXT

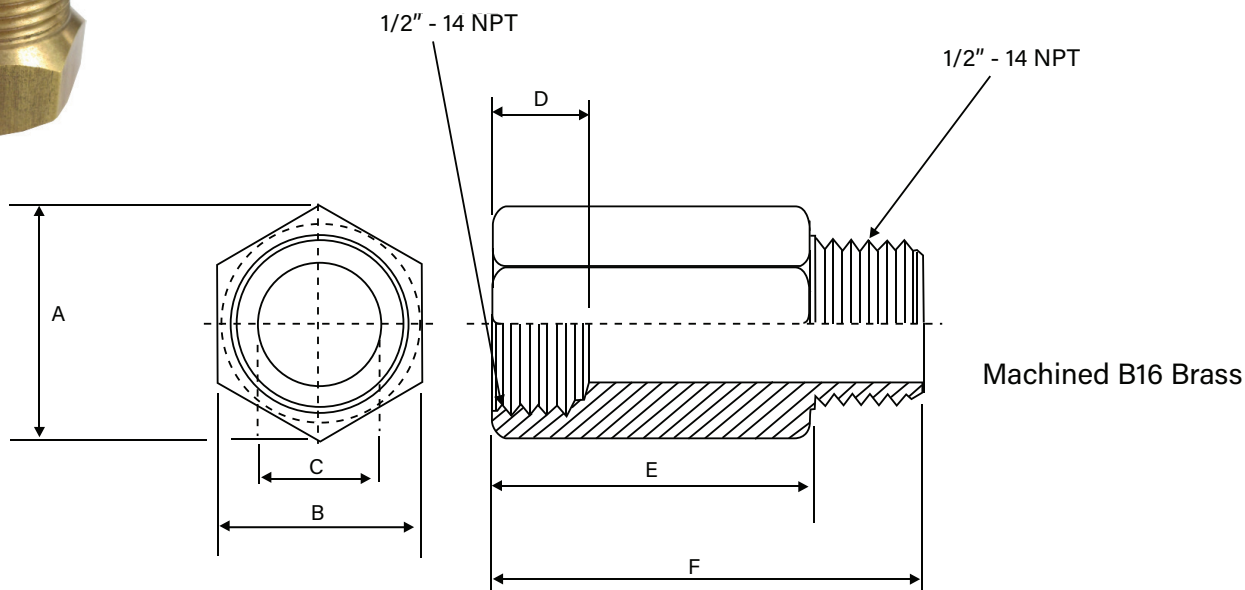

Size	A	B	C	D	E	F
1/2" x 1/2"	1.079"	9.49"	.567"	.516"	.535"	1.031"
1/2" x 3/4"	1.079"	9.49"	.567"	.531"	.787"	2.016"
1/2" x 1"	1.079"	9.49"	.567"	.547"	.965"	1.5"
1/2" x 1 1/2"	1.079"	9.49"	.567"	.547"	1.488"	2.016"
1/2" x 2"	1.079"	9.49"	.567"	.535"	2.008"	2.532"
3/4" x 1/2"	1.346"	1.181"	.709"	.524"	.539"	1.035"
3/4" x 3/4"	1.346"	1.181"	.709"	.62"	.68"	1.27"
3/4" x 1"	1.346"	1.181"	.709"	.62"	.91"	1.5"

**Caution:** Do not exceed 15 foot pounds torque. Over tightening will cause the sprinkler extension to crack and leak. See additional warnings regarding waiver of liability and use.

**Note:** This product is covered by additional disclaimers regarding the suitability and use. Purchaser and installer take full responsibility for the use of this product and Lansdale will not accept any liability for the failure of this product or damage caused by it.

PROJECT		APPROVAL STAMP
PROJECT:		<input type="checkbox"/> APPROVED
ADDRESS:		<input type="checkbox"/> APPROVED AS NOTED
ENGINEER:		<input type="checkbox"/> NOT APPROVED
SUBMITTAL DATA:		REMARKS:
NOTES 1:		
NOTES 2:		