

HEAVY HEX NUTS

MODEL LVHHN



FEATURES:

Heavy hex nuts are slightly wider and thicker than standard hex nuts. They are often referred to as structural nuts as they are often used to construct structural steel for buildings, bridges and other structures. These heavy hex nuts (ASTM A 194 Gr 2H) are specifically recommended for use with bolts in high temperature and high pressure applications, such as the flanging of valves, pumps, strainers and other piping items.

- Zinc Plated for Corrosion Resistance
- Material Spec - ASTM A 194 GR 2H
- Dimensions - In Accordance with ANSI/ASME B18.2.2

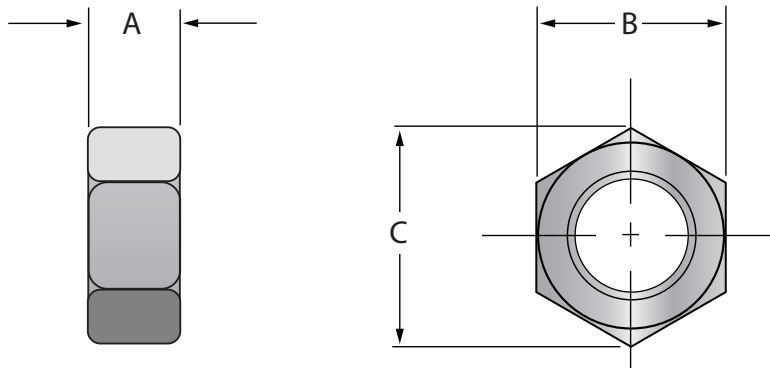

HEX NUT MODEL LVHHN			
NOM DIA (IN)	WIDTH ACROSS FLATS "B"	WITH ACROSS CORNERS "C"	THICKNESS "A"
3/8	.68	.790	.360
7/16	.75	.860	.422
1/2	.875	1.0	.485
9/16	.9375	1.075	.550
5/8	1.063	1.20	.61
3/4	1.25	1.40	.75
7/8	1.4375	1.60	.86
1	1.625	1.85	1.0

PROJECT	APPROVAL STAMP
PROJECT:	<input type="checkbox"/> APPROVED
ADDRESS:	<input type="checkbox"/> APPROVED AS NOTED
ENGINEER:	<input type="checkbox"/> NOT APPROVED
SUBMITTAL DATA:	REMARKS:
NOTES 1:	
NOTES 2:	