



LEVER HANDLE GROOVED BUTTERFLY VALVE

MODEL LV-GTV



DESCRIPTION:

Lansdale's Lever Handle Grooved Butterfly Valve Model LV-GTV are indicating type valves designed for use in commercial plumbing and HVAC systems where a visual indication is required as to whether the valve is open or closed. These valves have a 10-position locking handle that can therefore be used as a flow control or isolation valve. They are used, for example, as system control valves and Isolation valves. They have grooved inlet and outlet connections that are suitable for use with grooved end pipe couplings that are approved for commercial plumbing and HVAC systems.

- Rated for 300 PSI
- Ductile iron - ASTM 536 body & disc
- Body - Epoxy coated
- Disc - EPDM, FKM, or NBR encapsulated

INSTALLATION

The Lansdale's Lever Handle Grooved Butterfly Valve is easily installed using two grooved rigid couplings, such as those manufactured by GEMLOCK. The installer should refer to the grooved manufacturer's instructions when installing this valve and make sure that the handle that operates the valve is easily accessible after installation.

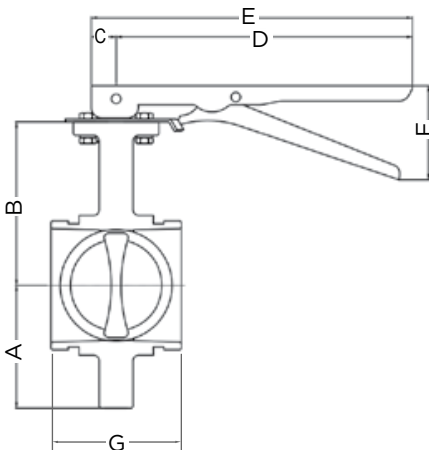

NOMINAL VALVE SIZE (In.)	PIPE OD (In.)	NOMINAL DIMENSIONS (In.)							WEIGHT (Lbs.)
		A	B	C	D	E	F	G (END TO END)	
2	2.37	2.85	3.50	.87	10.35	11.25	2.56	3.19	4.0
2-1/2	2.88	3.35	4.45	.87	10.35	11.25	2.56	3.8	6.40
3	3.5	3.58	4.72	.87	10.35	11.25	2.56	3.8	7.50
4	4.5	4.29	5.71	.87	10.35	11.25	3.29	4.54	10.80
5	5.56	5.16	6.54	.87	10.35	11.25	3.29	5.21	16.76
6	6.63	5.71	7.05	.87	10.35	11.25	3.29	5.21	23.0
8	8.63	6.69	8.03	.87	10.35	11.25	3.29	5.8	32.40

PROJECT	APPROVAL STAMP
PROJECT:	<input type="checkbox"/> APPROVED
ADDRESS:	<input type="checkbox"/> APPROVED AS NOTED
ENGINEER:	<input type="checkbox"/> NOT APPROVED
SUBMITTAL DATA:	REMARKS:
NOTES 1:	
NOTES 2:	