

OS&Y RESILENT SEATED GATE VALVE FLANGED X GROOVED ENDS, 3" - 8"

MODEL LVOSYFG



GENERAL SPECIFICATIONS:

- Complies with AWWA C515
- Heavy duty handwheel and attachment nut
- Triple O-Rings stem seal
- NPT brass plug on body
- Groove to AWWA C606 standard
- Temperature range: 33° F to 170° F
- Working pressure 300 PSI
- Internally and externally fusion bonded epoxy powder coated (FBE)

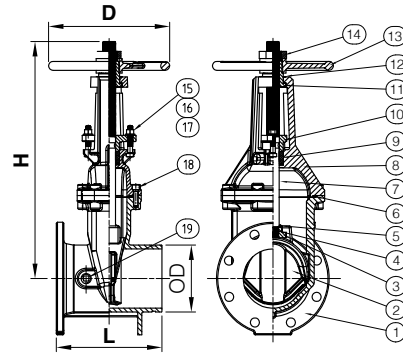

VALVE DIMENSIONS							
Size	2½	3	4	6	8	10	12
	In.	In.	In.	In.	In.	In.	In.
OD	2⅞	3 ½	4 ½	6 ⅝	8 ⅝	10¾	12¾
L	7½	8	9	10 ½	11½	13	14
H (open)	16⅞	18⅞	21⅞	29⅞	36 ⅞	44½	52
H (close)	13¾	15 ¾	17 ¾	23¼	28¼	34¼	40½ ¹⁶
D	7¼	10	10	12	14	17½	17½

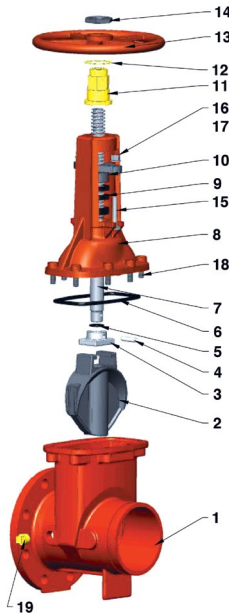

MATERIAL SPECIFICATIONS			
No.	PART	MATERIAL	ASTM SPEC.
1	Body	Ductile Iron	536 65-45-12
2	Wedge	Ductile Iron	EPDM Encapsulated
3	Wedge Nut	Stainless Steel	AISI 304
4	Pin	Stainless Steel	AISI 420
5	O-Ring	EPDM	
6	Gasket	EPDM	
7	Stem	Stainless Steel	AISI 304
8	Bonnet	Ductile Iron	A536 65-45-12
9	Packing	Graphite	
10	Gland	Ductile Iron	A536 65-45-12
11	Yoke Nut	Bronze	C95200
12	Washer	Brass	
13	Handwheel	Ductile Iron	A536 65-45-12
14	Handwheel Nut	Ductile Iron	A536 65-45-12
15	Bolts	Stainless Steel	A2-70
16	Nuts	Stainless Steel	A4-70
17	Washers	Stainless Steel	AISI 304
18	Bonnet Bolt	Carbon Steel	Gr8.8, Zinc Plated
19	Plug	Malleable Iron	

PROJECT	APPROVAL STAMP
PROJECT:	<input type="checkbox"/> APPROVED
ADDRESS:	<input type="checkbox"/> APPROVED AS NOTED
ENGINEER:	<input type="checkbox"/> NOT APPROVED
SUBMITTAL DATA:	REMARKS:
NOTES 1:	
NOTES 2:	