

LANSDALE

VALVE & MANUFACTURING

1040 Broadway Westville, NJ 08093 / Phone: (800)908-0523 / Fax: (856)456-9223 / www.gemfiresprinkler.com

SWING CHECK VALVE

Model Numbers:

1/2"	700-225-00020	3/4"	700-225-00040	1"	700-225-00060
1 1/4"	700-225-00080	1 1/2"	700-225-00100	2"	700-225-00120

- Full Floating Clapper Assembly
- Sizes: 1/2" IPS - 2" IPS
- Female x Female
- Rated Pressure: 175 psi
- Contains Lead. Not for use in water systems intended for human consumption

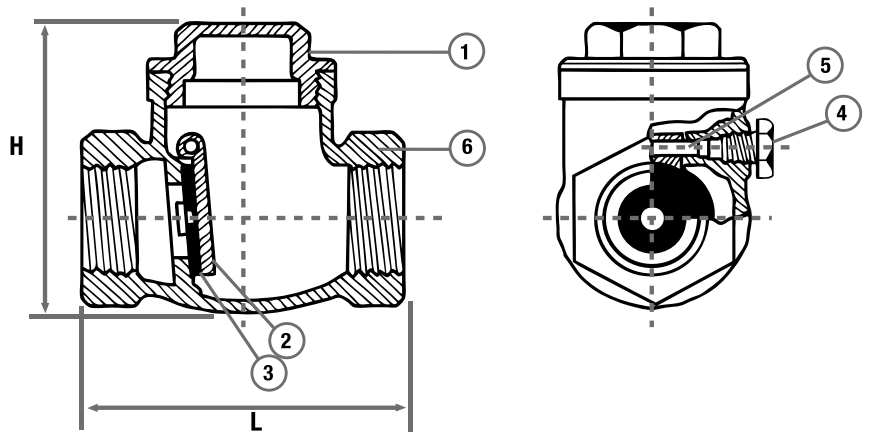

MATERIAL LIST

NUMBER	DESCRIPTION	MATERIAL
1	Cap	Brass (ASTM-UNS B584 C85710)
2	Disc/ Disc Holder	Brass (ASTM-UNS B584 C85710)
3	Seat Packing	Rubber NBR (SAE NO 1052#)
4	Lock Bolt	Brass (ASTM-UNS B16 C36000)
5	Pin	Brass (ASTM-UNS B16 C36000)
6	Body	Brass (ASTM-UNS B584 C85710)

SIZE	L	H
1/2	2.09"	1.44"
3/4	2.36"	1.58"
1"	2.62"	1.79"
1 1/4"	3.19"	2.05"
1 1/2"	3.55"	2.19"
2"	4.22"	2.74"

PROJECT		APPROVAL STAMP
PROJECT:		<input type="checkbox"/> APPROVED
ADDRESS:		<input type="checkbox"/> APPROVED AS NOTED
ENGINEER:		<input type="checkbox"/> NOT APPROVED
SUBMITTAL DATA:		REMARKS:
NOTES 1:		
NOTES 2:		

Revision: 1/2019