

LANSDALE

VALVE & MANUFACTURING

SWING CHECK VALVES

With LEVER & WEIGHT

Model LVLWCV

- Resilient seated (EPDM rubber face on the ductile iron disc)
- Bronze seat ring
- "Clear Waterway" design per AWWA C508 Standard
- Fusion Bonded Epoxy Coated Interior and Exterior per AWWA C550 Standard
- Rated at 200 psi (working pressure)
- Flanged ends to ANSI B16.1, Class 125
- 33.8° - 125.6° temperature range
- May be installed vertically or horizontally for vertical installations, flow must be in upward direction

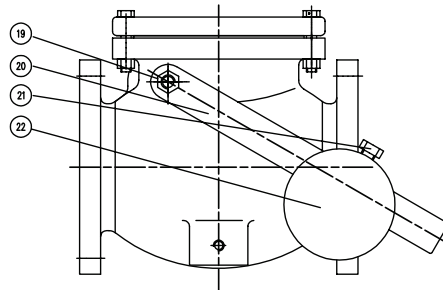
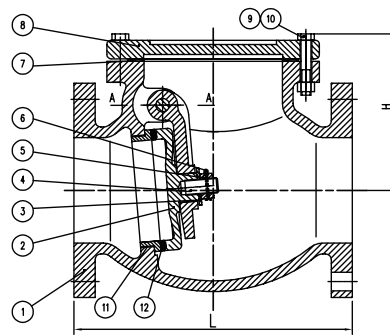

A-A Section

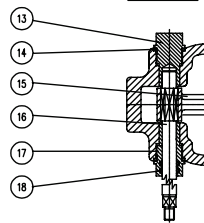

No	PART	MATERIAL
1	Body	ASTM A536 65-45-12
2	Disc	ASTM A536 65-45-12
3	Washer	Carbon Steel
4	Bolt	SS304
5	Nut	SS304
6	Pin	SS304
7	Gasket	Graphite
8	Bonnet	ASTM A536 65-45-12
9	Bolt	Carbon Steel
10	Nut	Carbon Steel
11	Seat	ASTM B62
12	Disc Ring	Rubber EPDM
13	Nut	ASTM B16
14	Washer	PTFE
15	Hanger	ASTM A536 65-45-12
16	Stem	AISI 304
17	Bushing	ASTM B16
18	O-Ring	EPDM
19	Nut	Carbon Steel
20	Lever	Carbon Steel
21	Bolt	Carbon Steel
22	Weight	ASTM A126 Class B

Dimensions									
Size	2"	2.5"	3"	4"	5"	6"	8"	10"	12"
L	8"	10"	11"	13"	14"	16"	19½"	22"	26"
H	4.92	5.39	5.79	6.54	7.48	8.54	10.43	11.81	13.46

PROJECT		APPROVAL STAMP
PROJECT:		<input type="checkbox"/> APPROVED
ADDRESS:		<input type="checkbox"/> APPROVED AS NOTED
ENGINEER:		<input type="checkbox"/> NOT APPROVED
SUBMITTAL DATA:		REMARKS:
NOTES 1:		
NOTES 2:		