

LANSDALE

VALVE & MANUFACTURING

1040 Broadway Westville, NJ 08093 / Phone: (800) 908-0523 / Fax: (856) 456-9223 / www.gemfiresprinkler.com

SWING CHECK VALVES W/FLANGED ENDS



Model Numbers:

3"	700-225-00940	4"	700-225-00960	6"	700-225-01000
8"	700-225-01020	10"	700-225-01040	12"	700-225-01060

General Specifications:

- Resilient seated (EPDM rubber face on the ductile iron disc)
- Bronze seat ring
- UL listed/ FM Approved
- "Full Waterway" design
- Flanged ends to ANSI B16.1, Class 12
- Fusion Bonded Epoxy Coated Interior and Exterior per AWWA C550 Standard
- Rated at 300 psi (working pressure)
- 33.8° - 125.6° temperature range
- May be installed vertically or horizontally
- For vertical installations, flow must be in upward direction



Sizes 5" to 12"

Sizes 2" to 4"

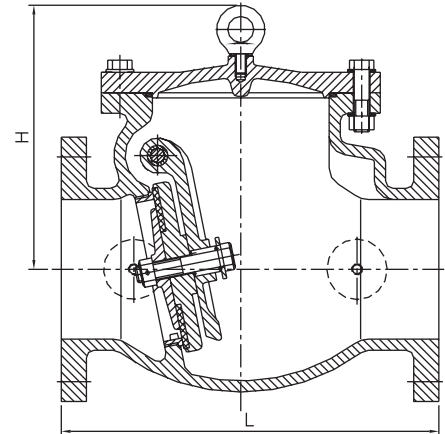
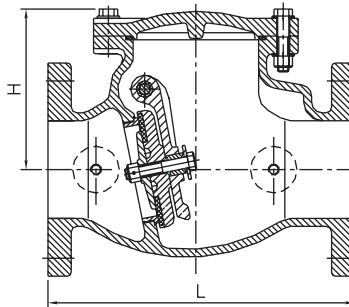

Part Name	Material	ASTM Spec.
Body	Ductile Iron	A536 65-45-12
Seat Ring	Bronze	B62 C83600
Disc Ring	Rubber	EPDM
Disc Ring Retainer	Ductile Iron	A536 65-45-12
Retainer Bolt	Stainless Steel	AISI 304
Disc	Ductile Iron	A536 65-45-12
Bonnet	Ductile Iron	A536 65-45-12
Gasket	Rubber	EPDM
Hinge Pin	Stainless Steel	AISI 304
Clapper Arm	Ductile Iron	A536 65-45-12
Pin Plug	Stainless Steel	AISI 304
NPT Plug	Malleable Iron	Commercial
Bonnet Bolts	Carbon Steel	A307 B
Eyebolt	Carbon Steel	A307 B

Dimensions (Inch)

Size	2	2½	3	4	5	6	8	10	12
Length	8	10	11	13	14	16	19 ½	22	26
Height	5 3/16	5 11/16	5 7/8	6 7/8	11 3/4	13 7/8	13 9/16	15 9/16	17 1/2
Weight (Lbs.)	25	29	37.5	55	88	110	129	480	621

*Special Order

PROJECT		APPROVAL STAMP	
PROJECT:		<input type="checkbox"/> APPROVED	
ADDRESS:		<input type="checkbox"/> APPROVED AS NOTED	
ENGINEER:		<input type="checkbox"/> NOT APPROVED	
SUBMITTAL DATA:		REMARKS:	
NOTES 1:			
NOTES 2:			

Revision: 1/2019